

Alu-Cab™

ULTIMATE OVERLAND PRODUCTS



the
Khaya

THE
KHAYA



There's an old joke that asks: What is the best 4x4 on the market?
Answer: a rental vehicle.

Admittedly, the joke's a bit stale these days, but love it or hate it, the humour does highlight the rigours of rental life. Imagine a vehicle that spends 80% of its life off-road, in remote regions, driven by people with very little mechanical sympathy, and very often, limited overland and/or 4x4-driving experience.

Well, that's exactly what our campers endure every year – more than 5 million combined kilometres of remote African travel within the rental market. Needless to say, these journeys serve as the perfect trial and error field test – each of which shapes the development, durability, reliability, and of course, the user-friendliness of our campers.



Alu-Cab



2 OR 4 SLEEPER CAMPERS

Ultimately, this 16-year evolution has brought us to the **2-sleeper and 4-sleeper Khaya Campers**. These drive-off units are designed to maintain your vehicle's versatility, without compromising on creature comforts and functionality.

Boasting a dry weight of approximately 400 kg, the 2-sleeper Khaya does a great job of balancing functional cabin space with a compact exterior design that doesn't prohibit access to remote campsites. Much of this is made possible thanks to the Khaya's tried and trusted aluminium construction.

But the real gem is being able to park the Khaya, off your vehicle (at home or at your office) so that it's ready to rock and roll for any adventure.



the
Khaya

there are no boundaries to your freedom,
no routes to worry about,
and no trailers to hitch, just load up and hit the road!



2-sleeper Interior

Alu-Cab™

ULTIMATE OVERLAND PRODUCTS

FEATURES & DIMENSIONS

Length (Overall):	2 800 mm
Height (Overall roof closed):	1 450 mm
Width (Overall):	1 850 mm
Height (Overall, roof opened):	3 100 mm
Dry Weight / Fully Kitted Weight:	Approx. 400 kg Empty basic, 770kg
Colour:	Silver or Black

the
Khaya



Khaya unit off vehicle

KHAYA VARIOUS OPTIONS

KHAYA DRIVE-OFF MAIN UNIT	2 SLEEPER PACK - SILVER / BLACK	4 SLEEPER PACK - BLACK / SILVER
Khaya Basic	Khaya Comfort	Khaya Family
INCLUDES: Hi-level stop light, mounting kit, mattress and tent	INCLUDES: Electrical 220V charger, DC/DC charger, Extension lead, 7 x LED Dual colour lights and wiring loom - Excludes Battery	INCLUDES: Electrical 220V charger, DC/DC charger, Extension lead, 7 x LED Dual colour lights and wiring loom - Excludes Battery
	INTERNAL KITCHEN KIT INCL: Dometic Unit, Basic plumbing,	INTERNAL KITCHEN KIT INCL: Small sink, Basic plumbing,
	External Kitchen kit, All Canvas bags, Midgie net at rear door, Recovery grid.	External Kitchen kit, All Canvas bags, Midgie net at rear door, Recovery grid.

OPTIONAL EXTRAS



- » Table slide and shower
- » Alu-Cab table
- » Duck board
- » Duetto geyser
- » Planar - diesel air heater
- » Khaya universal gas bottle holder in front cupboard
- » Khaya side prep table - new spec prep table
- » Spade bracket
- » Spade
- » Khaya swing arm (vehicle specific)
- » 150w solar panel
- » Shadow awning
- » Shadow awning / khaya mounting bracket
- includes awning deflector
- » Shadow awning side wall kit - khaya
- » Shadow awning gutter
- » Jerry can holder on LHS side - gen 2
- » Load bars 1450mm (to fit solar panel) - black/silver
- » Rieco titan legs and brackets
- » Land cruiser side boxes
- » Land cruiser sub frame

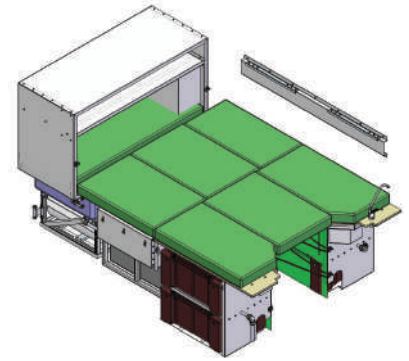

Second
bed set-up

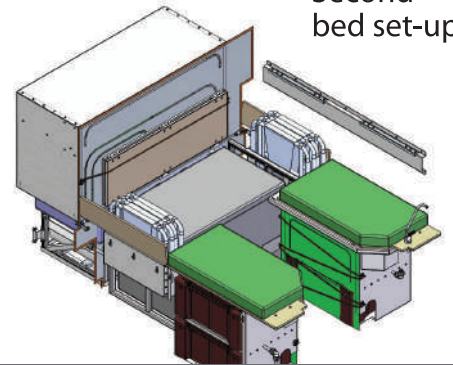

4 SLEEPER INTERIOR

Alu-CabTM

ULTIMATE OVERLAND PRODUCTS

the
Khaya



Contact: queries@alu-cab.co.za