

KENNY

OPERATING INSTRUCTIONS

Washing machine
EURONOVA
1000WA 355/10/F

CE

Index

| | | |
|--------------------------|---|---------|
| Installation | Safety instructions | 3 |
| | Electrical connection | 3 |
| | Inlet hose | 3 |
| | Manual | 4 |
| | Removal of transport safety bars | 4 |
| | Adjustment lever: operating position – driving position | 5 |
| | Prior to the first wash | 5 |
| | Connection and installation | 6 |
| Instructions | Programme selection | 7 |
| | Programme setting | 9 |
| | Adding the correct amount of detergent | 10 |
| | Protection of the environment | 10 |
| | Fabric selection | 11 |
| | Programme examples | 11 |
| Cleaning and Maintenance | Care instruction | 12 |
| | Cleaning the intake filter | 12 |
| | Cleaning and prevention of limescale formation | 12 |
| Summary | Problem checks | 13 – 14 |
| | Opening the door in an emergency | 13 |
| | Emergency draining | 13 |
| | Cleaning of drain filter | 13 |
| | Problem check list | 14 |
| | Tips | 15 |
| | Conditions of guarantee | 15 |
| | Importer and custom service | 16 |
| | Producer | 16 |
| | Technical specifications | 16 |
| | Product information sheet | 17 |
| Disposal | 17 | |

Safety instructions



Attention

- Removing the transport safety bars (p. 4)!
- Please ensure you read the instructions carefully before using your machine.
- This washing machine is designed solely for the cleaning of laundry and garments equipped with, and in accordance with the necessary HLCC labels, and during use must be protected from interference by unauthorized persons (i.e. children).
- This washing machine is not intended for use by persons (e.g. children) whose physical, sensory or mental incapacity or lack of experience and knowledge prevents the appliance from being used safely. They must be supervised or instructed in their use by the person responsible for their safety.
- Children must not play with the washing machine and this must be supervised.
- This washing machine should not be left unattended during use.



Attention

- This product must not be modified in anyway.
- Always switch of the cold water supply after using your machine.
- Doing your own repairs or repairs that are not carried out professionally can have an effect for the device safety and for warranty.
- Switch off the washing machine with the main switch after each wash.



Attention

- Every care was taken of respect the environment in the manufacture and packaging of this product. Would you please ensure that the packaging and, when the time comes, the “old” machines are disposed of according to the rules for protection of the environment. Detach the mains lead and remove it together with the plug. Destroy the lock on the door. In this way you can prevent children from shutting themselves in and the risk of suffocation!

Electrical connection

- Plug socket 230 V / 50 Hz
- Rated effect 2,2 kW
- Fuse: min. 10 A
- Kindly note the rating label on the back of the machine.



Attention

- If the power cord of the machine is damaged, it must be replaced with another cord. The power cord can get you from the manufacturer or its service company.

Inlet hose



Attention

- Water inlet hose is already fixed. Before starting the programme please check waterproofness.

Manual

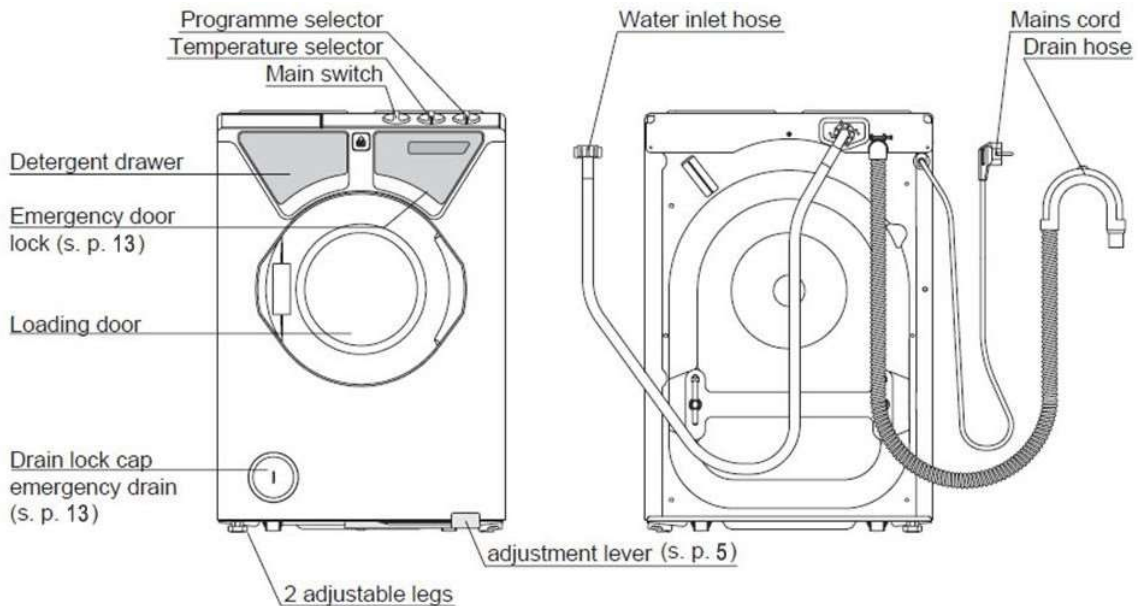

Removal of transport safety bars

The transport safety bars must be removed before using your machine (see Pic 1 - 3) or your machine could be severely damaged.

- Withdraw **both** bars from their sockets (Pic 1 - 2).
- Seal the holes with the plastic plugs provided (Pic 3).
- In the event of your machine having to be transported, i.e. moving house it is essential for the transport bars to be put back into the machine.
- Drain any remaining water from the machine (see emergency draining page 13).
- In order to avoid any water leaking from your machine during transport, the machine should always remain upright.

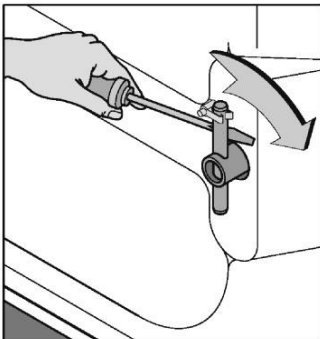

Pic. 1

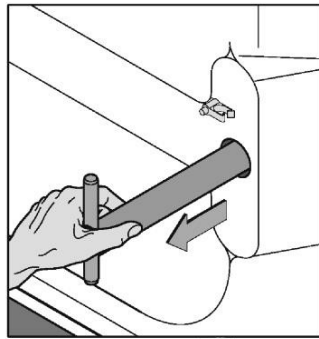

Pic. 2

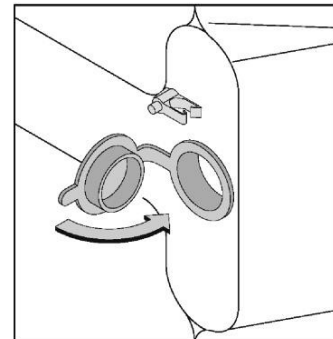

Pic. 3

Adjustment lever: operating position – driving position

- 1) Adjustment lever in position 1 = operating position
This position is essential whenever the machine is started.

Check that

- the machine is standing evenly on the floor and that it cannot slip.
- the machine is connected to the mains.
- the water intake and runoff hoses are properly connected

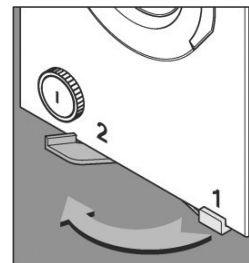

- 2) Adjustment lever in position 2 = driving position
The machine can now be rolled on the four casters.

If you have to move the machine to a new position, always disconnect from the mains and disconnect the water intake and runoff hoses first.
When disconnecting the hoses do not forget that they might still contain some water.

Prior to the first wash



Attention

The washing machine must be properly installed and connected.

The washing machine was tested before leaving the factory. To make sure that any traces of water used in the test are removed, wash for the first time without introducing any dirty linen.

- do not put any dirty linen into the machine
- open the water cock
- place 1/2 measuring cup of detergent in the chamber foreseen for the main detergent (see page 10)
- start the „easy-care / fine wash” programme at 60°C and let it run its course

The washing machine is now clean and ready for operation.

Connection and installation

Open the loading door

- connect machine to electricity supply
- turn the main switch to position “”.

Water inlet connection

- It is intended for **cold-water connection** only.
- Screw the intake hose on to the tap.
- The washing machine is intended for a water pressure of 1 to 10 bars. If the pressure exceeds 10 bars, a pressure reducing valve must be installed in the water-line. If the pressure is less than 1 bar, the flow rate regulator behind the strainer (in the water inlet connection of the machine) must be removed.
- Check if all hose's connections are leak tight!

Drain connection

- Do not kink the drain hose.
- Hang the drain hose over the edge of the sink or wash basin. The bend in the hose must not be raised more than 1 m above the surface on which your machine stands (so that drainage can function properly).
- Secure the drain hose with the hose holder supplied. Pull the hose holder to the center of the hose bend onto the drain hose and secure against slipping. If required, use a weight or any other suitable means to ensure that the drain hose cannot slip.
- Tight connection to a non-ventilated drain requires special steps and should be carried out by a plumber only.



Setting up and starting

- Ensure the unit is on an even, firm surface.
- All four screw-mounting feet must stand firmly on the floor.
- To set up the machine, adjust one or more of the screw-mounting feet by loosening the counter-nuts.
- After adjusting the screw-adjustment feet, tighten the relative lock nuts again in the direction of the arrows (with a SW 17 spanner).
- Turn on the tap and check the run off hose.

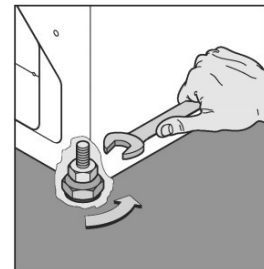

Attention

- Always ensure the drain hose is free of obstructions of any kind, since this will have an adverse effect on the smooth running of your machine.
- Only install your machine in a room protected from frost.
- The company excepts no responsibility for improper use, or maintenance work carried out by unauthorized service personnel resulting in water damage.

Programme selection

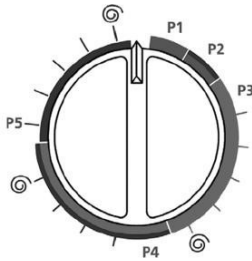
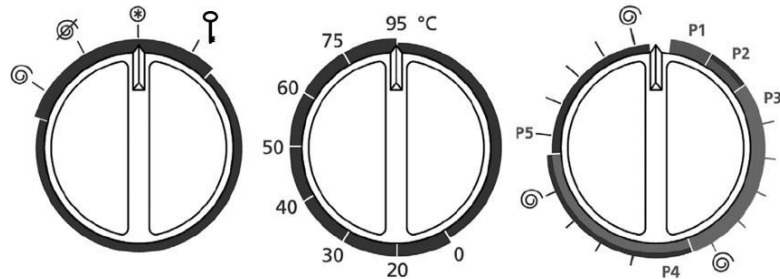

Programme selector

With this selector switch you may choose between:

- | | | |
|-----------|---|--------------------------|
| P1 | Whites and coloureds with prewash | from 40°C to 95°C |
| P2 | Whites and coloureds without prewash | from 40°C to 95°C |
| | P2 + 40°C = „eco 40-60“ | |
| | For a temperature of 40° C it is “the program for cotton laundry that is marked as washable at 40° C or 60° C” according to Regulation (EU) 2019/2014. | |
| P3 | Easy-care fabrics - higher water level | from cold to 60°C |
| | P3 + 20°C = „20°C“ | |
| | For a temperature of 20° C it is “the program for lightly soiled cotton laundry for cleaning at a nominal temperature of 20° C” according to Regulation (EU) 2019/2023. | |
| P4 | Delicate fabrics / Curtains | from cold to 40°C |
| P5 | Wool | from cold to 40°C |

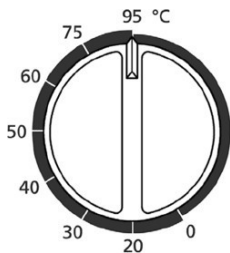

Temperature selector

- The temperature selector switch allows you to select any temperature required, from cold to 95°C.
- Please pay attention to the care marks on the laundry to be washed. Our indications regarding temperature selection serve as guidelines only and are not binding.
- Please assure that the correct temperature for the selected program has been chosen.
- An automatically temperature limit for the programs wool (5) at 40°C and delicate wash (4) at 60°C gives additional security, independent of the selected temperature.
- For lightly soiled laundry, the intensive effect of high temperatures is not likely to be required in most cases.

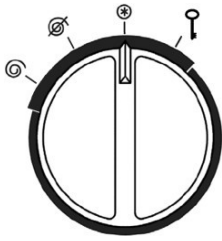

Main switch

The main switch allows you to choose between the following settings.

- „⊙“ - ON with Spin Dry - spinning at 1000 rpm (final spin speed).
- „⊗“ - ON without Spin Dry

The main switch also serves as door opener.

To open the door turn the main switch to the position “⌚”.

Through the pulse function with automatically release the main switch returns afterwards to the position “⊙”. For reasons of safety the door can only be opened about one minute after finishing of program.



Attention

After each wash or drying cycle the main switch should be set to the position “⊙”.



Attention



Programs that wash for a long time and at lower temperatures are usually the most effective in terms of energy consumption.

The spin speed has an impact on noise emissions and residual moisture: the higher the spin speed in the spin cycle, the higher the noise emissions and the lower the residual moisture.

Programme setting

P1 Whites and Coloureds with prewash • INTENSIVE

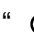
40°C - 95°C, rated capacity 3 kg

- turn programme selector in position 1
- set temperature acc. to HLCC care labeling guide
- turn main switch on position “” - ON with Spin Dry, or “” - ON without Spin Dry

Note: Normal soiled clothes should never be washed in a pre-wash programme since the standard wash programme will achieve the same results and save water, detergent and energy.

P2 Whites and Coloureds without prewash

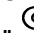
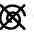

40°C - 95°C, rated capacity 3 kg

- turn programme selector in position 2
- set temperature acc. to HLCC care labeling guide
- turn main switch on position „” - ON with Spin Dry, or „” - ON without Spin Dry
- „eco 40-60“

For the temperature of 40°C, this is the program "eco 40-60". This program is able to clean normally soiled cotton laundry declared to be washable at 40°C or 60°C, together in the same washing cycle, and to which the information on the energy label and in the product information sheet relates. This program is used in accordance with EU regulations 2019/2014 and 2019/2023.

P3 Easy-care fabrics

cold to 60°C, rated capacity 1,5 kg

- turn programme selector in position 3
- set temperature acc. to HLCC care labeling guide
- turn main switch on position „” - ON with Spin Dry, or „” - ON without Spin Dry
- „20°C“

For a temperature of 20°C, this is a program which is able to clean lightly soiled cotton laundry, at a nominal temperature of 20°C.

P4 Delicate fabrics / Curtains - higher water level

cold to 40°C, rated capacity 1,5 kg

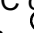
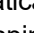
- turn programme selector in position 4
- set temperature acc. to HLCC care labeling guide (automatical temperature limit at 60°C)
- turn main switch on position „” - ON with Spin Dry - spin speed of this program is 500 rpm or on position „” - ON without Spin Dry

P5 Wool

cold to 40°C, rated capacity 1 kg

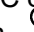
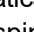
- turn programme selector in position 5
- set temperature acc. to HLCC care labeling guide (automatical temperature limit at 40°C)
- turn main switch on position „” - ON with Spin Dry - spin speed of this program is 500 rpm or on position „” - ON without Spin Dry

Adding the correct amount of detergent

Using the correct amount of detergent is determined by the following factors:

- size and type of your washing machine
- your water supply (hard or soft water)
- degree of soiling of your laundry
- amount of fabric in your drum
- type and brand of detergent used

Before adding detergent, please check if:

- Your washing machine is loaded to its max capacity. This saves energy and water.
- Your laundry is badly soiled i.e. greasy, ground in dirt etc.
- The amount of detergent to be used tallies with the type of water (i.e. hard / soft) according to detergent manufacturer's instructions

Use suitable detergents. Different detergents are suitable for washing different textile materials, washing temperatures and washing programs. Follow the instructions on the detergent you have chosen.

Protection of the environment

Your washing machine protects the environment, by saving up to 30 % of detergent because:

- Your machine is fitted with an ECO - Valve
(This prevents any unused detergent from being discharged)
- The amount of powder needed as indicated by detergent manufacturers on their packaging is designed for 5 kg machines.
--> Your machine however has a max capacity of 3 kg.
--> Use less for smaller quantities.

Compartment I

pre-wash, bleach or spotting agents

Compartment II

main-wash

Compartment III

conditioner, softening agents

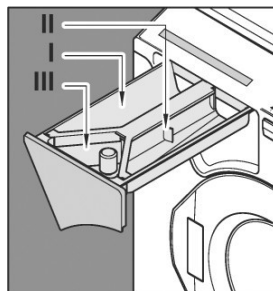

Advice

- Using of additional water softeners is effective in the range II (10 – 16° dH) of hardness of water. Than you can use amount of detergent like in the range I (0-10° dH) of hardness of water.
- It is not necessary to use fabric softener when you dry clothes in dryer.

Fabric selection

Sorting the various types of fabric

- According to garment labels
- Extend of soiling
- Colours

New clothes should be washed separately at the first time since it often contains an excess of color.

Always fill your machine according to manufacturer's instructions, in order to wash economically. Avoid overloading your machine, since this dramatically reduces the cleaning effect.

Programme examples

| | rated capacity (kg) | programme duration (h.:min.) | energy consumption (kWh/cycle) | water consumption (liters/cycle) | maximum temperature (°C) | remaining moisture content / spinning speed (% / rpm) |
|--|------------------------|---------------------------------|-----------------------------------|-------------------------------------|-----------------------------|--|
| Program „eco 40-60“ P2 + 40°C | 3 | 1:40 | 0,425 | 49 | 33 | 61 / 995 |
| Program „20°C“ P3 + 20°C | 1,5 | 1:19 | 0,160 | 38 | 19 | 65 / 1000 |
| Hot wash whites and coloureds P2 + 75°C | 3 | 1:55 | 1,040 | 49 | 60 | 61 / 1000 |
| Delicates P4 + 40°C | 1,5 | 0:51 | 0,330 | 27 | 32 | 99 / 500 |
| Hot wash whites and coloureds with prewash P1 + 60°C | 3 | 2:00 | 0,926 | 53 | 52 | 65 / 1000 |

Information that the values given for programmes other than the “eco 40-60” programme are indicative only.

Cleaning and maintenance



Attention

Before starting cleaning, maintenance and removal of faults, pull the mains plug out of the socket and close the water-tap!

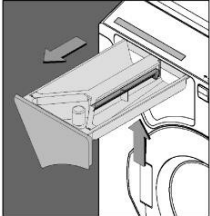

Pic. 1

Advise

Remove the detergent drawer for cleaning at regular intervals.

- Pull out the drawer (Pic. 1).
- Lift the drawer slightly, and remove completely.

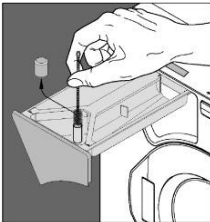

Pic. 2

- Clean detergent drawer with warm water.
- Remove siphon cover and clean with warm water.
- Clean the filler channel for softener if necessary with a bottle brush and remount siphon cover. (Pic. 2).
- When drawer removed check if there is any remaining detergent in the shaft of the drawer and clean if necessary.
- Clean housing, control panel and loading door with a soft cloth.

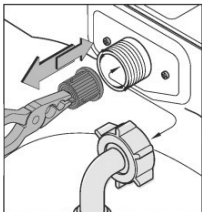

Cleaning the intake filter

- Turn off the water and unscrew the intake hose from the machine.
- Take the coarse filter out and clean it.
- Replace the filter.
- Screw the intake hose back on to the tap and check that the connection is watertight.

Cleaning and prevention of limescale formation

- The removal of limescale deposits is generally not necessary with the range of water l (0 - 10° dH) and with the correct dosage of the detergent.
- The best protection against limescale is prevention, which consists in the use of water softeners.
- Use only anti-scale cleaners intended for washing machines and follow their instructions for use.
- It is recommended to use anti-scale cleaners about once a quarter of the year.



Attention

Never remove limescale mechanically.

Problem checks



Attention

Before starting cleaning, maintenance and removal of faults, pull the mains plug out of the socket and close the water-tap!

Opening the door in an emergency

- Switch off main switch.
- If there is water in the machine (see emergency draining)
--> DANGER: The water could be very hot!
- Ensure the drum has stopped rotating.
- The emergency door opener (see picture) must be accessible at all times even with built in machines. Pull the switch downwards using a screwdriver or needle to carry out this procedure (see picture).
- The door flicks open.

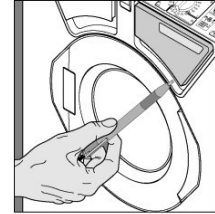

Emergency draining

If the programme is interrupted by a malfunction or in some other way the water remaining in the machine can be removed through a hose.

- Use a coin to remove the cover disc from this drain lock cap.
- Once the hose has been folded out to its full length the water in the machine can be drained out into an appropriate container. Important: If the failure occurs during the heating phase it is essential that you allow the water to cool before draining to avoid the danger of scalding.
- Replace the hose into the rear of the cap.
- Cover with the cover plate.

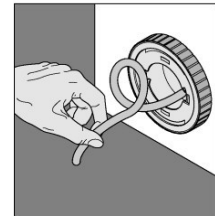
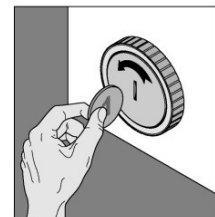

Cleaning of drain filter



Attention

- By adding the laundry, there is a possibility that foreign objects could get into the washing machine and block the drain pump.
- Check the filter time to time that there are no foreign objects.

Advise:

Check always drain filter before you call customer service.

Opening the drain filter

The drain filter must only be opened, when the machine is empty.

- Press in the outer ring of the locking plug (Pic. 1),
- Turn anticlockwise 1/4 turn (Pic. 2).
Press once again and turn another 1/4 turn, to release the plug.
- Remove the drain filter and clean (Pic. 3).
- In order to close, turn drain filter twice to the right
(turn - push - turn).

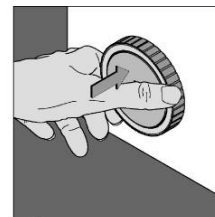

Pic. 1

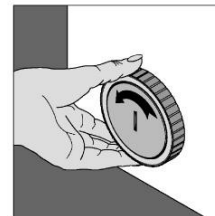

Pic. 2

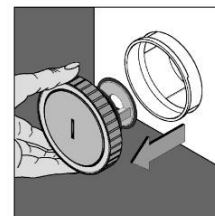

Pic. 3

Problem check list

| Faults | Possible causes | Solving the problem |
|---|---|---|
| drum stationary, no function | <ul style="list-style-type: none"> - no electricity supply - no programme selected - main switch on position “ ⊗ “ - loading door open | <ul style="list-style-type: none"> - plug in another socket check fuse - select program (see p. 7 - 9) - turn main switch to “ ⊙ “ or “ ⊗ “ position - close loading door |
| machine moves, does not stand properly | <ul style="list-style-type: none"> - does not stand correct on the floor | <ul style="list-style-type: none"> - adjust machine properly – see instruction page 6 |
| no spin | <ul style="list-style-type: none"> - main switch on position “ ⊗ “ - the washing is unevenly distributed | <ul style="list-style-type: none"> - turn main switch to “ ⊙ “ position - if the laundry is unevenly distributed, the machine will automatically return to the wash cycle for a short period, until the spin cycle can commence. If this is not possible the programme will end without spinning. --> Loosen the washing by hand, and turn the programme selector to “ ⊙ “ position. |
| little or no detergent enters the machine | <ul style="list-style-type: none"> - detergent drawer blocked - incorrect programme selection | <ul style="list-style-type: none"> - clean drawer (see p. 12) - see programme selection (see p. 7 - 9) |
| conditioner in the machine at programme start | <ul style="list-style-type: none"> - too much conditioner in compartment III | <ul style="list-style-type: none"> - fill to max. - line only |
| conditioner compartment flooded | <ul style="list-style-type: none"> - intake valve blocked | <ul style="list-style-type: none"> - clean detergent drawer and valve (see p. 12) |
| traces of water on floor | <ul style="list-style-type: none"> - excess lather dripping from machine - detergent drawer open - inlet hose leaking - drain trap fitted incorrectly | <ul style="list-style-type: none"> - correct detergent dosage - close drawer - check connection of inlet hose on machine and cold fill tap. - see p. 13 |
| washing not cleaned | <ul style="list-style-type: none"> - too much or too little of detergent - incorrect programme selection - incorrect temperature selection | <ul style="list-style-type: none"> - correct detergent dosage (see p. 10) - see Programme selection (p. 7 – 9) - see Programme selection (p. 7 – 9) |
| washing is damaged | <ul style="list-style-type: none"> - sharp object in drum - sharp object in clothing - faulty fabrics | <ul style="list-style-type: none"> - check inside drum - check pockets |
| powder residues in washing | <ul style="list-style-type: none"> - interrupted water supply - detergent in conditioning drawer | <ul style="list-style-type: none"> - check water supply - clean detergent drawer (see p. 12) |
| The water is not pumped off | <ul style="list-style-type: none"> - the run off system is blocked or the hose has a kink - the drain pump is clogged | <ul style="list-style-type: none"> - check hose and runoff - clean drain pump (see p. 13) |

If your washing machine fails to operate correctly after having carried out the procedures listed above, please contact your customer service.

Tips

The machine should not be used to store worn clothing. Damp, worn clothing is liable to mold and staining.

Flushing problems (e.g. residues in the detergent chamber) may be possible with highly concentrated powder products. In this case the measuring cups (if available) in the detergent packages should be used.

With some detergents (liquid or powder) foam may develop even in the final spin cycle. This does not impair the rinsing result.

White detergent residues may be visible, after completion of a wash cycle particularly on dark textiles. This is due to insufficient rinsing. Generally this is the insoluble water softeners in modern phosphate free detergents.

Remedy: Shake or brush it off, try another detergent or use a liquid detergent.

Before putting the laundry in the machine check, whether there are any metal parts on or in the laundry that could work loose e.g. metal buttons, bra wiring etc. Such parts could work into the machine and cause a rattling noise.

Repairs of this kind cannot be undertaken free of charge, even during the guarantee period.

Conditions of guarantee

The guarantee is valid from date of supply to the end user for:

- a) 24 months in domestic use within the family,
- b) 6 months in commercial or other similar use (i.e. hotels, guesthouses or community use etc.).

In order to claim under the guarantee the faulty appliance must be taken to the official after-sales service agent together with proof of purchase (copy of the invoice or receipt) and in original packaging (or other safe-shipping packaging). The guarantee covers the costs for work and material. Repairs under guarantee do not extend the period of guarantee accorded. Guarantee repairs are only valid in the country of purchase of the appliance.

The guarantee shall be invalid or prematurely discontinued if damages are due to any of the following causes: utilization of the appliance in the commercial sector, exterior influences, non-professional installation, non-observance of the instructions for use or operating instructions, force majeure, inappropriate use, intervention by non-authorized persons as well as normal wear and tear. Also excluded damage are damage due to dropping or falling, water or operating with incorrect electrical power.

Spare parts:

Spare parts are available for a minimum period of the 10 Years.

Importer and customer service

Kenny Nordic AB

Ymervägen 54
182 67 Djursholm

Sverige

Tel: 08-7149898
Email: info@kenny.se
www.kenny.se

Producer

R-FIN s.r.o.

Nádražní 335
742 45 Fulnek
Czech republic

Tel: +420 556 764 101
E-mail: odbyt@r-fin.cz
www.r-fin.cz

Technical specifications

| | |
|--------------------|------------------|
| High: | 67 cm |
| Width: | 46 cm |
| Height: | 46 cm |
| Max. capacity: | 3 kg dry washing |
| Heating: | 2000 W |
| Power consumption: | 2200 W |
| Protection: | 10 A |
| Fusing: | 230 V~/50Hz |
| Spin speed: | 1000 U/min |
| Weight: | 49,5 kg |

Product information sheet

Product information sheet contents information about model of washing machines saved in the product database according Regulation (EU) 2019/2014.

Load this QR code (Quick Response Code) to view the information.

This QR code is also listed on the energy label.

Model identification mark: EUMENIA 1000



Disposal



Attention

- This product has been manufactured and packaged in environmentally friendly aspects.
- We ask you to dispose of the packaging properly and use the washing machine according to the rules.



At the end of the product's useful life, please dispose of it at appropriate collection points provided in your country.



